

## K086MMUS-9

### Connector 1

2.92mm Male Plug 40 GHz

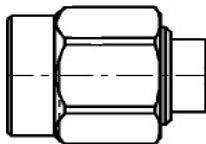

### Connector 2

2.92mm Male Plug 40 GHz

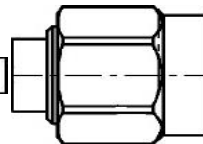

**Length Dimensions** inch/cm  
**Overall end-to-end:** 9/22.86  
**Between Ref. Planes:** 8.78/22.30  
**Less Connectors:** 8.14/20.68  
**C1 Ref. Plane (R/P):** 0.11/0.28  
**C2 Ref. Plane (R/P):** 0.11/0.28

**Cable Type:** 0.086" Semi-Rigid, bare copper  
**Jacket:** None  
**Length:** 9 inches long overall  
**Phase matching:** N/A  
**Test Data:** N/A  
**Rotation:** N/A

Cable Marker typically placed center cable includes P/N, Serial, and Manufacturer

**These specifications are subject to change without notice.**

**Component images are not to scale.**

### SPECIFICATIONS:

**FREQUENCY RANGE:** DC to 40 GHZ

**RETURN LOSS:** >16dB

**INSERTION LOSS (up to above frequency limit):** <1.1 dB/ft @ 18 GHz, <1.4 dB/ft @ 27 GHz, <2.0 dB/ft @ 40 GHz, <2.4 dB/ft @ 67 GHz (typical), +0.3 dB per connector

**CONNECTOR 1:** 2.92mm M, direct solder, straight, Precision Connector Inc. P/N: 3146, or equivalent

**CONNECTOR 2:** 2.92mm M, direct solder, straight, Precision Connector Inc. P/N: 3146, or equivalent

**CABLE TYPE:** Bare copper semi-rigid outer conductor, (magnetic steel wire center conductor), 0.086" (2.2mm) diameter nominal, Micro-Coax P/N: M17/133-RG-405, or equivalent

**MINIMUM INSIDE BEND RADIUS:** 0.125" (3.2mm) with slotted mandrel special tooling, 0.500" (12.4mm) without special tooling

**SOLDER:** SN63 tin/lead (standard), RoHS 5 Compliant

### RF COAX INC.

1725 San Felipe Road, Suite 3  
Hollister, CA 95023 USA  
TEL: 831-635-0820, FAX: 831-785-2990  
sales@rfcoax.com www.rfcoax.com  
All rights reserved  
File No: 0.1/0.25,8.6/21.84,0.1/0.25

**CAGE 1WF56**

RF Cable Assembly, 2.92mm M to 2.92mm M, 0.086 bare copper semi-rigid, 40 GHz, 9-inches long overall

**TYPE:** Product Specification

**REVISION:** A **Date :** 07/22/2025

**Item :** K086MMUS-9