

GS086FMTC-35CMR

Connector 1

GPPO (SMPM) Female Jack 65 GHz

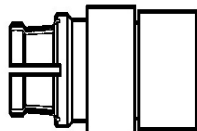

Connector 2

SMA Male Plug 27 GHz

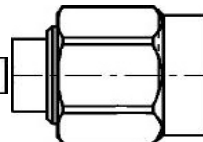

Length Dimensions

inch/cm

Overall end-to-end: 13.78/35

Between Ref. Planes: 13.67/34.7218

Less Connectors: 13.06/33.17

C1 Ref. Plane (R/P): 0/0

C2 Ref. Plane (R/P): 0.11/0.28

Cable Type: 0.086" Semi-Rigid, tin-plated copper, non-magnetic, RoHS

Jacket: None

Length: 35 cm long overall

Phase matching: N/A

Test Data: N/A

Rotation: N/A

Cable Marker typically placed center cable includes P/N, Serial, and Manufacturer

These specifications are subject to change without notice.

Component images are not to scale.

SPECIFICATIONS:

FREQUENCY RANGE: DC to 27 GHZ

RETURN LOSS: Unspecified

INSERTION LOSS (up to above frequency limit): <1.1 dB/ft @ 18 GHz, <1.4 dB/ft @ 27 GHz, <2.0 dB/ft @ 40 GHz, <2.4 dB/ft @ 67 GHz (typical), +0.3 dB per connector

CONNECTOR 1: GPPO/SMPM F, direct solder, straight, genuine Corning Gilbert P/N: B014-D11-01, or equivalent

CONNECTOR 2: SMA M, direct solder, straight, Radiall P/N: R125.052.002, or equivalent

CABLE TYPE: Tin-plated copper semi-rigid outer conductor, (copper wire center conductor), 0.086" (2.2mm) diameter nominal, Micro-Coax P/N: UT-85C-TP, or equivalent. NOTE: Connectors may be very slightly magnetic due to flash nickel underplate for example depending on those selected.

MINIMUM INSIDE BEND RADIUS: 0.125" (3.2mm) with slotted mandrel special tooling, 0.500" (12.4mm) without special tooling

SOLDER: 96.5Sn3.0Ag0.5Cu (SAC305) Pb-free, COMPLIANT WITH EU Directive RoHS 3 (2015/863)

RF COAX INC.

1725 San Felipe Road, Suite 3
Hollister, CA 95023 USA
TEL: 831-635-0820, FAX: 831-785-2990
sales@rfcoax.com www.rfcoax.com
All rights reserved
File No: 0.06/0.14, 13.44/34.13, 0.13/0.32

CAGE 1WF56

RF Cable Assembly, GPPO F to SMA M, 0.086 tin-plated copper semi-rigid, non-magnetic, 27 GHz, 35cm long overall, RoHS

TYPE: Product Specification

REVISION: A **Date :** 05/14/2025

Item : GS086FMTC-35CMR